

Aero Brake & Spares

Revised Component Maintenance Manual

Main Brake Assembly, P/N 5003096

Illustrated Parts List

Fig. Item	Part Number	Airline Part No.	Nomenclature	Eff. Code	Units Per Assy.
1-1	5003096*		BRAKE ASSEMBLY (Order -6)	A	RF
-1A	5003096-1*		BRAKE ASSEMBLY (Order -6)	B	RF
-1B	5003096-2		DELETED		
-1C	5003096-3*		BRAKE ASSEMBLY (Order -6) BRAKE	D	RF
-1D	5003096-4*		ASSEMBLY (Order -6)	E	RF
-1E	5003096-5*		BRAKE ASSEMBLY (Order -6)	F	RF
-1F	5003096-6		BRAKE ASSEMBLY (Order -6)	G	RF
-1G	5003096-7		BRAKE ASSEMBLY (Order -6)	H	RF
10	GYN145		. NUT, Self-locking		4
-20	GYS225P116		. BOLT, Brake (GYS225-P116)	ABDEG	1
20A	GYS225P128		. BOLT, Brake (GYS225-P128)	FH	1
30	MS20002C5		. WASHER, Countersunk		4
-40	GY165MSP40		. BOLT, Brake	ABDEG	3
40A	GY165MSP47		. BOLT, Brake (GY165MS-P47)	FH	3
50	9544027		. BACKING PLATE SUBASSEMBLY		1
60	GY18B7		.. RIVET (GY18B-7)		12
60ALT	AB18B7		.. RIVET (V0GDP5) (FAA-PMA Sup 2)		12
70	GY18B1		.. RIVET (GY18B15)		12
70ALT	AB18B15		..RIVET (V0GDP5) (FAA-PMA Sup 2)		12
80	5006029		.. WEAR PAD		12
-80A	9536248		.. WEAR PAD (Alternate for item 80)		12
-90	5003147*		. ROTATING DISK (Replaced by 90A)	ABD	2
-90A	5006425-1		. ROTATING DISK	EG	2
-90B	5006888*		. ROTATING DISK	F	2
90C	5006888-1		. ROTATION DISK	FH	2

- Item not illustrated

* Item not procurable – use until stock depletion

Those items printed in BLUE are stock items with Aero Brake & Spares, Inc.

ABSC[®] Component Maintenance Manual

32-43-32

Page 1005

Publication AP-455, Rev 8 Jun 11/04

Oct. 17/06

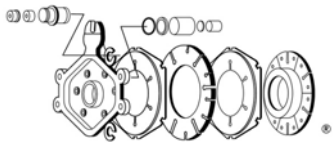

Aero Brake & Spares

Revised Component Maintenance Manual

Main Brake Assembly, P/N 5003096

Illustrated Parts List

Fig. Item	Part Number	Airline Part No.	Nomenclature	Eff. Code	Units Per Assy.
1-100	9544028		. STATIONARY DISK SUBASSEMBLY	ABDEG	1
-100A	5006892		. STATIONARY DISK SUBASSEMBLY	FH	1
-110	GY18A15		.. RIVET (GYR18A-15	ABDEG	24
-110ATL	AB18A15		.. RIVET (V0GDP5)	ABDEG	24
-110A	GYR8A23		.. RIVET (GYR8A-23)	FH	24
120	5006029		.. WEAR PAD		24
-120A	9536248		.. WEAR PAD (Alternate for item 120) (See effect code)	ABDEG	24
-130	9550634*		. TUBE, Torque (Replaced by 130A)	ABDE	1
-130A	5006905		. TUBE, Torque	G	1
130B	5006894		. TUBE, Torque	FH	1
140	FN12-02		. NUT, Self-locking (V56878)		4
-150	9535045		. GRIP & TUBE SUBASSEMBLY (Replaced by 150B)	ABDEG	4
-150A	5001423		. GRIP & TUBE SUBASSEMBLY (Replaced by 150C)	FH	4
150B	5012939		. SWAGE TUBE SUBASSEMBLY	ABDEG	4
150BALT	8532939		. SWAGE TUBE SUBASSEMBLY	ABDEG	4
150C	5012940		. SWAGE TUBE SUBASSEMBLY	FH	4
150CALT	8532940		. SWAGE TUBE SUBASSEMBLY	FH	4
151	5010711		.. SWAGE, Adjuster	ABDEGH	4
151ALT	8530711		.. SWAGE, Adjuster (V0GDP5)	ABDEGH	4
152	5012943		.. TUBE, Self-adjusting Swage	ABDEG	4
152ALT	8532943		.. TUBE, Self-adjusting Swage	ABDEG	4
153	5012941		. TUBE, Spacer	ABDEH	4
153A	5012942		. TUBE, Spacer	FH	4
-160	9535044		. PIN, Return	ABDEG	4
160ALT	8535044		. PIN, Return (V0GDP5)	ABDEG	4

- item not illustrated

* Item not procurable – use until stock depletion.

Those items printed in BLUE are stock items with Aero Brake & Spares, Inc.

ABSCI® Component Maintenance Manual

32-43-32

Publication ap-455 Rev 8

Page 1006

Oct. 17/06

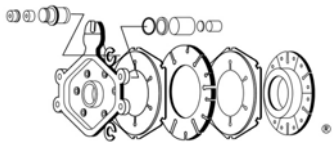

Aero Brake & Spares

Revised Component Maintenance Manual

Main Brake Assembly, P/N 5003096

Illustrated Parts List

Fig. Item	Part Number	Airline Part No.	Nomenclature	Eff. Code	Units Per Assy.
160A	5001421		. PIN, Return	FH	4
-170	9544029*		. PRESSURE PLATE SUBASSEMBLY (Order item 170B)	A	1
170A	5005117*		. PRESSURE PLATE SUBASSEMBLY (Order item 170B)	B	1
170B	5005117-1		. PRESSURE PLATE SUBASSEMBLY	ABDEG	1
170C	5006890		. PRESSURE PLATE SUBASSEMBLY	FH	1
180	GY18B9		.. RIVET	ABDEG	20
180ALT	AB18A9		.. RIVET (0GDP5) (FAA-PMA Sup # 2)	ABDEG	20
180A	GYR8B8		.. RIVET	FH	20
190	9536249		.. WEAR PAD	A	2
190A	5005119		.. WEAR PAD	BDEG	1
190B	5007328		.. WEAR PAD	FH	1
200	5006029		.. WEAR PAD		8
200A	9536248		.. WEAR PAD (Alternate for item 200) (See effect code)	ABDEG	8
-210	9535042		.. INSULATOR DISK (replaced by 210B)	ABDEG	5
-210ALT	8535042-1		.. INSULATOR DISK (0GDP5) (FAA-PMA Sup PM8340SC-T)	ABDEG	5
-210A	5006895		.. INSULATOR DISK (replaced by 210C)	FH	5
210AALT	8536895-1		.. INSULATOR DISK (0GDP5) (FAA-PMA Sup PM8318SC-T)	FH	5
-210B-	9535042-1		.. INSULATOR DISK (replaced by 210)	ABDEG	5
210BALT	8535042-1		.. INSULATOR DISK (0GDP5) (FAA-PMA Sup PM8340SC-T)	ABDEG	5
210C	5006895-1		.. INSULATOR DISK (replaced by 210A)	FH	5
210CALT	8536895-1		.. INSULATOR DISK (0GDP5) (FAA-PMA Sup PM8318SSC-T)	FH	5
220	9536273		.. PISTON		5
220ALT	8536273		.. PISTON (0GDP5) (FAA-PMA Sup PM8075SC-T)		5
230	MS28774-216		.. RETAINER, Packing		5
-240	MS28775-216		.. PACKING, Preformed (Alt for 240A)	ABDEG	5

- Item not illustrated

* Item not procurable – use until stock depletion

Those items printed in BLUE are stock items with Aero Brake & Spares, Inc.