

Aero Brake & Spares

Revised Component Maintenance Manual
 737-100/200 Main Brake Assembly, P/N 2603442
 Illustrated Parts List

Fig. Item	Part Number	Airline Part No.	Nomenclature	Eff. Code	Units Per Assy.
1-120A	2605081		. PACKING, Preformed (Supersedes 2600099)		6
120A-ALT	8505081		. PACKING-Preformed (V0GDP5)		6
125	MS28774-219		. RING, Backup (V55284 910783) (Superseded by 2606799-219)		12
125A	2606799-219		. RING, Backup (Supersedes MS28774-219)		12
130	2601233		. PACKING, Preformed (Use until exhausted) (Superseded by 2605084)		6
130A	2605084		. PACKING, Preformed (Supersedes 2601233)		6
130A-ALT	8505084		. PACKING, Preformed (V0GDP5)		6
135	2604239		. SCREW, Machine		6
140	2604074		. PROTECTOR, Insulator		6
145	2604073		. INSULATOR		6
150	2602930		. SLEEVE, Alignment		6
155	2602863		. INSERT, Self-locking		6
160	2604085		. PISTON		6
165	2601230		. WIPER, Piston		6
170	2604233		. SLEEVE, Cylinder		6
175	MS9048-232		. PIN, Spring (V55284 909200K1)		1
180	2604225		. PISTON HOUSING & PLUG ASSY		1
185	MS21208F4-20		.. INSERT, Screw thread (V55284, 2603006)		4
185A	TH25028-50		.. INSERT, Self-tapping (V73957) (V55284, 2600715) (Oversize-For Service Repair)		AR
185B	H25028-50		.. INSERT, Self-tapping (V73957) (V55284, 2600829)(Second (Oversize – For Service Repair)		AR
190	406001		.. PLUG, Standard (V92555) (V55284, 953518-29)		6
190A	416001		.. PLUG, Oversize (V92555) (V55284, 953518-31)		AR
195	2603041		. RETAINER, Safety		
200	2603057		. PIN, Lining wear indicator		2
205	2601894		. WASHER, Key		2

Those items printed in BLUE are FAA-PMA by Aero Brake & Spares, Inc.

HONEYWELL® Component Maintenance Manual

32-40-05

Page 1005

Publication 12-562C Oct 15/91

Oct. 17/06

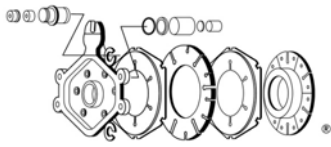

Aero Brake & Spares

Revised Component Maintenance Manual

737-200/300/400/500 Main Brake Assembly, P/N 2606672

Illustrated Parts List

Fig. Item	Part Number	Airline Part No.	Nomenclature	Eff. Code	Units Per Assy.
1-75	AN502-10-6		. . SCREW,Machine(V55284-80510)		2
80	MS35338-43		. . WASHER, Lock		2
85	146938		. . VALVE, Bleeder		2
90	2601079		. BUSHING, Machine thread		2
90A	2604446		. BUSHING, Bleeder screw (Service repair)		AR
95	151890		. PACKING, Preformed		2
95A	2604447		. PACKING, Preformed (Service repair, use with Bushing P/N 2604446)		AR
100	2606799-224		. RING, Packing backup	A	12
100A	2606799-224		. Ring, Packing backup	B,C,D	6
105	2605081		. PACKING, Preformed		6
105-ALT	8515081		. PACKING, Preformed (V0GDP5)		6
110	2606799-218		. RING, Packing backup	A	12
111	2606799-219		. RING, Packing backup	B,C,D	6
115	2605122		. PACKING, Preformed	A	6
116	2605084		. PACKING, Preformed	B,C,D	6
116-ALT	8505084		. PACKING, Preformed (V0GDP5)	B,C,D	6
120	2606718		. PIN, Insulator hold down	A	6
125	2602300		. PROTECTOR, Insulator	A	6
130	2606699		. INSULATOR, Piston (Superseded by P/N 2608844)	A	6
130A	2608844		. INSULATOR, Piston (Supersedes P/N 2606699)	A	6
135	149629		. CLIP, Split tubular	A	6
140	2606698		. PISTON,(Superseded by 2608422)	A	6
140A	2608422		. PISTON,(Supersedes items # (120 through 140)	A	6
141	2608279		. PISTON	B,C,D	6
145	2607044		. WIPER, Piston	A	6
145A	2602303		. WIPER, Piston (Optional)	A	6
146	2608287		. WIPER, Piston	B,C,D	6
150	2606700		. BUSHING, Piston	A	6
151	2608183		. BUSHINE, Piston	B,C,D	6

Those items printed in BLUE are FAA-PMA by Aero Brake & Spares, Inc.

HONEYWELL® Component Maintenance Manual

32-40-08

Page 1005

Publication 12-557E Rev 11 June5, 1998

Oct. 17/06